

# MA500-SERIES



## INCREMENTAL ENCODER 30Ø MM

Encoder with synchro flange and 3 mounting holes M3

- Ø 30 mm
- 4 mm solid shaft without face or 6 mm with face
- Enlarged sturdy bearings
- Ingress protection to IP67
- Standard: 7-35V Power supply, 100kHz  
2 Square Wave signals
- Options: Markerpulse, and/or inverted signals  
5V Power supply, 300 kHz
- Customization upon request



*Flexible and durable  
encoder for demanding  
applications*

 File E342441

 Conforms to european EMC directive  
89/336/EEC standards:  
EN61000-6-4 emission in industrial environments  
EN61000-6-2 immunity in industrial environments

# INCREMENTAL ENCODER MODEL

# MA500

Con. 1XU & 1XS

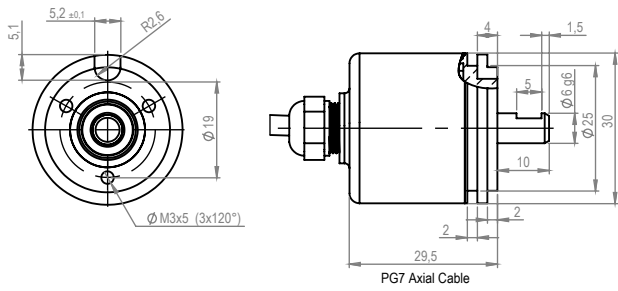

Con. 1LU

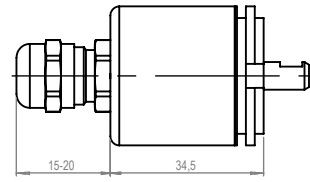

Con. 2XU & 2XS

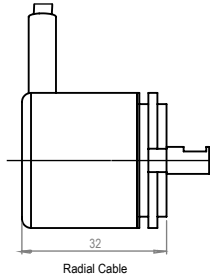
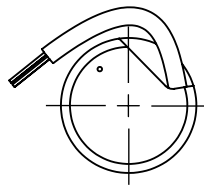
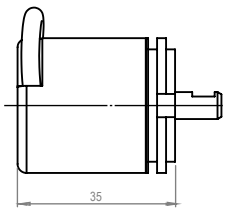

Con. 9

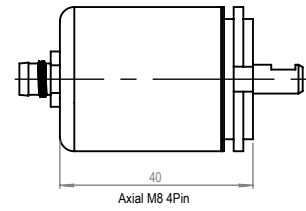

## ELECTRICAL SPECIFICATION, STANDARD

Power supply	Vcc 7–35 Vdc
Current consumption	Max 40 mA, without load
Output circuit	HTL
Low level output volt Max	<0,5 V at 20 mA load and 20°C
High level output volt	Min >Vcc-2V at 20mA load and 20°C
Short circuit protected	Yes
Polarity protected	Yes
Transient protected	Yes
Max load	70 mA

## OUTPUT SIGNALS, STANDARD

CCW rotation viewed from shaft end

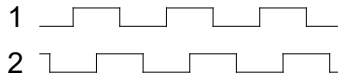

## SIGNAL ACCURACY

Dividing error max	±50 el°
Channel separation	90 ±25 el°
Max frequency	100 kHz
Operating temperature	40° till +80°C

## MECHANICAL SPECIFICATION

Housing	Aluminum, electrically conductive for increased interference protection
Sealing	IP67 dust and splash proof (IP66 at shaft outlet)
Bearings	Permanently greased
Bearing load at 1 000 rpm	
Radial	30 N Gives 50 000 hrs bearing life
Axial	30 N
Max rpm	3 000 (12 000)
Vibration	20g 20-2000 Hz
Chock	200g at 11 ms

## CONNECTIONS

1xU	Axial cable, Unitronic
1xLU	Axial cable, Unitronic
2xU	Radial cable, Unitronic
9	Axial 4-pin M8 male connector

## FUNCTIONS

U, Unitronic	9, Mating cable M8
1 Green	3 Blue
2 Yellow	4 Black
+V Brown	1 Brown
0V White	2 White
	Chassis

## MATING CONNECTOR

M8SR5,	Snap Straight 5m 4x0,25 PUR/PUR
M8SV2,	Snap Angled 2m 4x0,25 PUR/PUR
M8SV5,	Snap Angled 5m 4x0,25 PUR/PUR

## ORDERING CODE

Model	MA500	6	100	1	x	U
Shaft 4 or 6 mm						
Pulse rate 1-1250						
Connection						
x = cable length (m)						
Cable tvde						



Skogsvägen 1, SE-645 34 Strängnäs, Sweden  
 Tel: +46 152 33 11 90 Fax: +46 152 33 11 91  
 E-mail: info@emetaencoders.com